

SECTION XX'  
SCALE:1:100

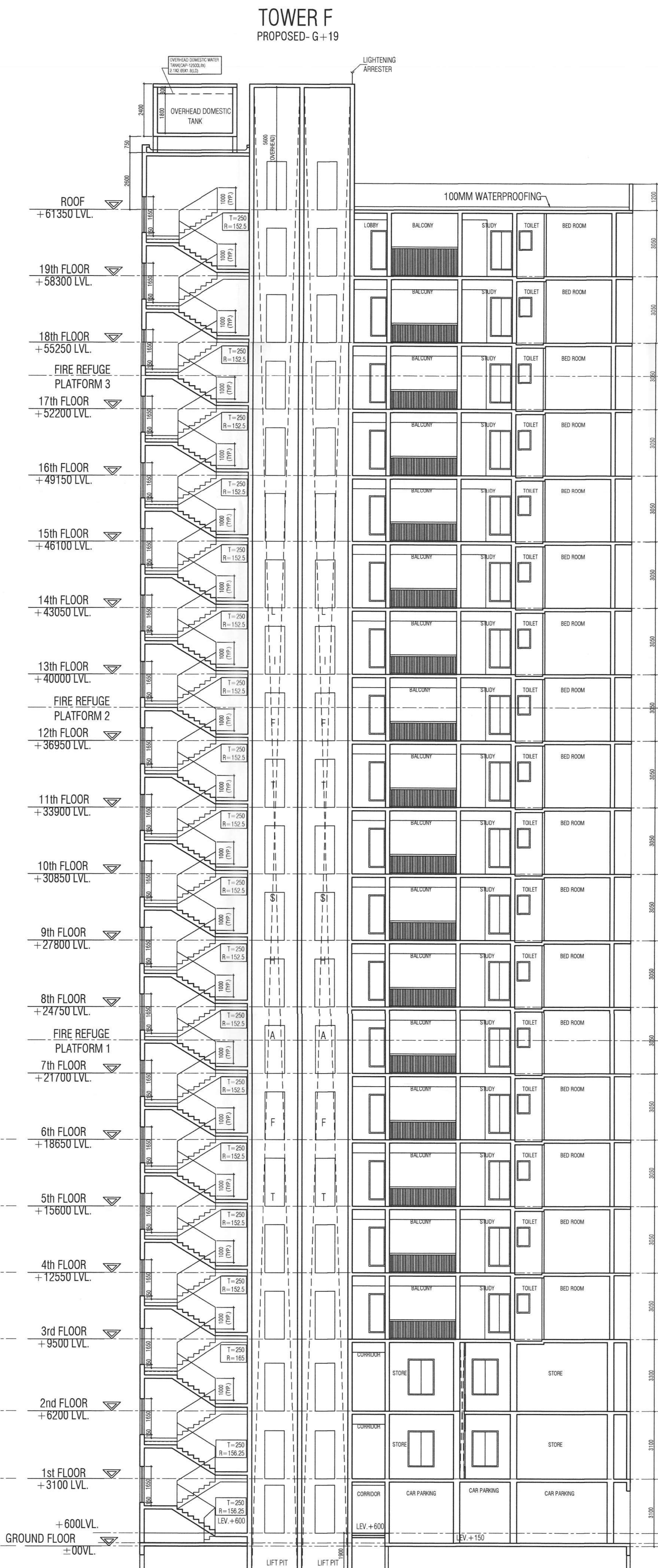

SECTION - ZZ  
SCALE:1:100

SCHEDULE OF DOORS & WINDOWS									
DOORS					WINDOWS				
MKD	WIDTH	HEIGHT	SILL	LINTEL	MKD	WIDTH	HEIGHT	SILL	LINTEL
SW1	1500	2050	150	2200	W1	1500	1800	400	2200
SW2	1800	2200	150	2200	W2	1200	1800	400	2200
W1	900	2200	00	2200	W2	1200	1800	400	2200
W2	900	2200	00	2200	W3A	900	1800	400	2200
W3	1200	2200	00	2200	W4	600	1800	400	2200
W4	750	2200	00	2200	W5	600	900	1800	2200
W5	2400	2200	00	2200	W6	450	1450	400	2200
W6	2300	2200	00	2200	SW	STAIRCASE WINDOW			
W7	1800	2200	00	2200	GLZ	GLAZING			
W8	1800	2200	00	2200	GLZ1	GLZ	1800	400	2200
W9	1300	2200	00	2200	Vw	Ventilation Window			
W10	1200	2200	00	2200					
W11	750	2200	00	2200					

- NOTE
1. ALL DIMENSIONS ARE IN MM UNLESS OTHERWISE MENTIONED.
  2. ALL EXTERNAL WALLS ARE 150 THK & INTERNAL WALLS ARE 125 THK.
  3. IF NOT STATED IN 1:4 CEMENT SAND MORTAR.
  4. ALL ELEVATION PROJECTIONS ARE 600 MM PROJECTED.
  5. DEPTH OF UNDERGROUND WATER RESERVOIR SHOULD NOT EXCEED THE DEPTH OF FOUNDATION.
  6. ANY DISCREPANCY IN SCALE, THE WRITTEN DIMENSION SHALL GOVERN.
  7. FOR SPECIFICATION OF MATERIALS & WORKMANSHIP N.B.C. 2016 TO BE FOLLOWED.
  8. OPEN TERRACE WITH LIME TERRACING OF RATIO 2:2:7.
  9. FLY ASH AND FLY ASH BASED MATERIAL WILL BE USED IN THE PROJECT.
  10. SOLAR ENERGY OF 2% OF THE CONNECTED LOAD WILL BE USED IN THIS PROJECT.
  11. FSR NO. : FSR/211862/40830000445
  12. AA MEMO NO. KOL/EAST/16/081022/688906

CERTIFICATE OF THE OWNER

I HAVE GONE THROUGH THE BUILDING RULES OF WEST BENGAL MUNICIPAL BUILDING RULES, 2007 AND ITS AMENDMENT & ALSO UNDERTAKE TO ABIDE BY THESE RULES DURING AND AFTER THE CONSTRUCTION OF THE BUILDING.

SRIJAN RESIDENCY LLP  
SRIJAN RESIDENCY LLP  
36/1A, ELGIN ROAD  
KOLKATA - 700020  
SIGNATURE OF OWNER

CERTIFIED THAT THE STRUCTURAL DRAWINGS AND DESIGN OF BOTH THE FOUNDATION AND SUPERSTRUCTURE OF THE BUILDING/BUILDINGS HAS BEEN MADE CONSIDERING THE SOIL TEST REPORT AS PER THESE RULES AND REGULATIONS MADE UNDER THE ACT AND ALSO CONSIDERING ALL POSSIBLE LOADS, SEISMIC LOADS AND THE MOMENTS GENERATED BY THE PROPOSED STRUCTURE AS PER THE BUREAU OF INDIAN STANDARD AND NATIONAL BUILDING CODE OF INDIA AND CERTIFIED THAT IT IS SAFE AND STABLE IN ALL RESPECT AND THESE PROVISIONS SHALL BE ADHERED TO DURING THE CONSTRUCTION.

ANKIT AGARWALA  
ENROLLMENT NO- STR/NKDA/10/00105  
SIGNATURE OF STRUCTURAL ENGINEER

UTPAL SANTRA  
ENROLLMENT NO- STR/NKDA/15/00006  
SIGNATURE OF STRUCTURAL REVIEWER

IT IS CERTIFIED THAT THE COMPREHENSIVE GEO-TECHNICAL REPORT ON SOIL INVESTIGATION HAS BEEN PREPARED BY ME FOR DESIGN AND CALCULATION OF THE FOUNDATION BY ANALYZING THE SOIL SAMPLE FOR ESTIMATING THE BEARING CAPACITY OF THE SOIL ON WHICH FOUNDATION OF THE STRUCTURE WILL BE CONSTRUCTED.

I SHALL ALSO CHECK THE NATURE OF THE SOIL AFTER EXCAVATION AT SITE SO THAT FOUNDATION IS EXTENDED UP TO APPROPRIATE DEPTH THAT HAS BEEN PROPOSED IN THE GEO-TECHNICAL REPORT.

JISHU PAL  
ENROLLMENT NO- STR/NKDA/10/00040  
Signature of Geotechnical Engineer

CERTIFICATE OF THE ARCHITECT

I CERTIFY THAT ALL THE ARCHITECTURAL DRAWINGS OF THE PROJECT AT MCDITY PROPERTY PVT. LD., REGD. NO. 1, 2, 3, 4, 5, 11(P), 12, 13, 14, 15, 16, 17, 18, 19, 20, 21, 22, 23, 24, 25, 26, 27(P), 28(P), 42, 43(P), 44(P), 74, 79, 80 & MAUZA BHATENDA, JL NO. 28, LR DAG NO: 485, 486, 488, PS- RAJARHAT, RAJARHAT-BISNUPUR 1 NO GRAM PANCHAYAT, NORTH 24 PGS, PIN - 700135 HAVE BEEN PREPARED BY ME CONFORMING WITH THE NEW TOWN PLANNING AND DEVELOPMENT REGULATIONS, 1973 AND THE NATIONAL BUILDING CODE OF INDIA. I SHALL BE HELD RESPONSIBLE FOR ANY INADEQUATE INFORMATION OR INFORMATION RECEIVED BY ME OR ANY OTHER PERSONS OF THESE RULES OR THE NATIONAL BUILDING CODE IS PROVIDED BY ANY OF THE DRAWING AND DOCUMENTS JOINED BY ME AND SUBMITTED TO THE SANCTIONING AUTHORITY FOR THE BUILDING SANCTION.

KAMAL KUMAR PERIWAL  
CA-95-18679  
SIGNATURE OF ARCHITECT  
KAMAL KUMAR PERIWAL  
ENROLLMENT NO- ACH/NKDA/10/00016

C.O.A REGISTRATION NO- CA-95-18679  
ARPAN E.A.S GUPTA  
B. ARCH (UD), (A) TRP, (BESTS)  
ARCHITECT, (C) TOWN PLANNER  
Reg. No. - TRP - NKDA/20/00003  
Signature of Town Planner  
ARPAN DASGUPTA  
ENROLLMENT NO- TPR/NKDA/20/00003

PROJECT :

PROPOSED G+18(TOWER B.E.G) G+19(TOWER A.C.D.F) STORED RESIDENTIAL BUILDING MAUZA-KALABERIA, JL NO.30, LR DAG NO : 1, 2, 3, 4, 5, 11(P), 12, 13, 14, 15, 16, 17, 18, 19, 20, 21, 22, 23, 24, 25, 26, 27(P), 28(P), 42, 43(P), 44(P), 74, 79, 80 & MAUZA BHATENDA, JL NO.28, LR DAG NO: 485, 486, 488, PS- RAJARHAT, RAJARHAT-BISNUPUR 1 NO GRAM PANCHAYAT, NORTH 24 PGS, PIN - 700135

CONTENTS :

SECTION -XX & SECTION -ZZ	
SUBMISSION DRAWING	SHEET NO. - 33/37

NORTH	REV. DATE	REV. NO.
SCALE	1:100	DEALT
DATE	09.03.2024	CHECKED
		M.B.

ARCHITECT :

MAHESHWARI & ASSOCIATES ARCHITECTS  
37A, BAKER ROAD, 2ND FLOOR, ALIPORE, KOLKATA-27  
TEL. : 65228584, www.architectm.com

REVISIONS: 01 - 01  
 02 - 02  
 03 - 03  
 04 - 04  
 05 - 05  
 06 - 06  
 07 - 07  
 08 - 08  
 09 - 09  
 10 - 10  
 11 - 11  
 12 - 12  
 13 - 13  
 14 - 14  
 15 - 15  
 16 - 16  
 17 - 17  
 18 - 18  
 19 - 19  
 20 - 20  
 21 - 21  
 22 - 22  
 23 - 23  
 24 - 24  
 25 - 25  
 26 - 26  
 27 - 27  
 28 - 28  
 29 - 29  
 30 - 30  
 31 - 31  
 32 - 32  
 33 - 33  
 34 - 34  
 35 - 35  
 36 - 36  
 37 - 37  
 38 - 38  
 39 - 39  
 40 - 40  
 41 - 41  
 42 - 42  
 43 - 43  
 44 - 44  
 45 - 45  
 46 - 46  
 47 - 47  
 48 - 48  
 49 - 49  
 50 - 50  
 51 - 51  
 52 - 52  
 53 - 53  
 54 - 54  
 55 - 55  
 56 - 56  
 57 - 57  
 58 - 58  
 59 - 59  
 60 - 60  
 61 - 61  
 62 - 62  
 63 - 63  
 64 - 64  
 65 - 65  
 66 - 66  
 67 - 67  
 68 - 68  
 69 - 69  
 70 - 70  
 71 - 71  
 72 - 72  
 73 - 73  
 74 - 74  
 75 - 75  
 76 - 76  
 77 - 77  
 78 - 78  
 79 - 79  
 80 - 80  
 81 - 81  
 82 - 82  
 83 - 83  
 84 - 84  
 85 - 85  
 86 - 86  
 87 - 87  
 88 - 88  
 89 - 89  
 90 - 90  
 91 - 91  
 92 - 92  
 93 - 93  
 94 - 94  
 95 - 95  
 96 - 96  
 97 - 97  
 98 - 98  
 99 - 99  
 100 - 100

Note: This NOC has been issued on the basis of documents submitted by the applicant and forwarded by the A&A, Executive Officer, North 24 Parganas Zilla Parishad. If there was material misrepresentation of fact or fraudulence in any part of representation of fact in connection with the above project including the concerned land, plans, drawings, designs, then, the NOC shall stand null and void.

STRUCTURAL DRAWINGS, STRUCTURAL DESIGN CALCULATIONS & SOIL TEST REPORTS ARE NOT CHECKED AND KEPT FOR RECORDS ONLY.

SANCTIONED & APPROVED

Executive Officer  
 Rajarhat Panchayati Samiti  
 Rajarhat, North 24 Parganas

NEWTOWN KOLKATA DEVELOPMENT AUTHORITY NOTE ALL RECOMMENDATIONS FROM POLLUTION CONTROL BOARD SHOULD BE THOROUGHLY FOLLOWED AT THE TIME OF CONSTRUCTION.  
 No Objection Certificate for Issuance of Building Permits for proposed 4th & 5th floor addition to existing building. Reference: No. 4624/NKDA/EPF/202/2023  
 Date: 01.10.2023  
 Building Particulars: Objection Certificate for issuance of building permit for proposed 4th & 5th floor addition to existing building. Reference: No. 4624/NKDA/EPF/202/2023. The proposed building is situated at Plot No. 4624, Sector 4, North 24 Parganas, West Bengal. The building is a multi-story residential building. The proposed addition is for 4th and 5th floors. The total area of the building is 1000 sq. m. The proposed addition is for 1000 sq. m. The building is situated at Plot No. 4624, Sector 4, North 24 Parganas, West Bengal. The building is a multi-story residential building. The proposed addition is for 4th and 5th floors. The total area of the building is 1000 sq. m. The proposed addition is for 1000 sq. m.

Approval Order No. 1621/EPF  
 Date: 25.10.2023  
 Valid up to: 24.10.2029

Assistant Architect  
 Executive Architect  
 Chief Architect

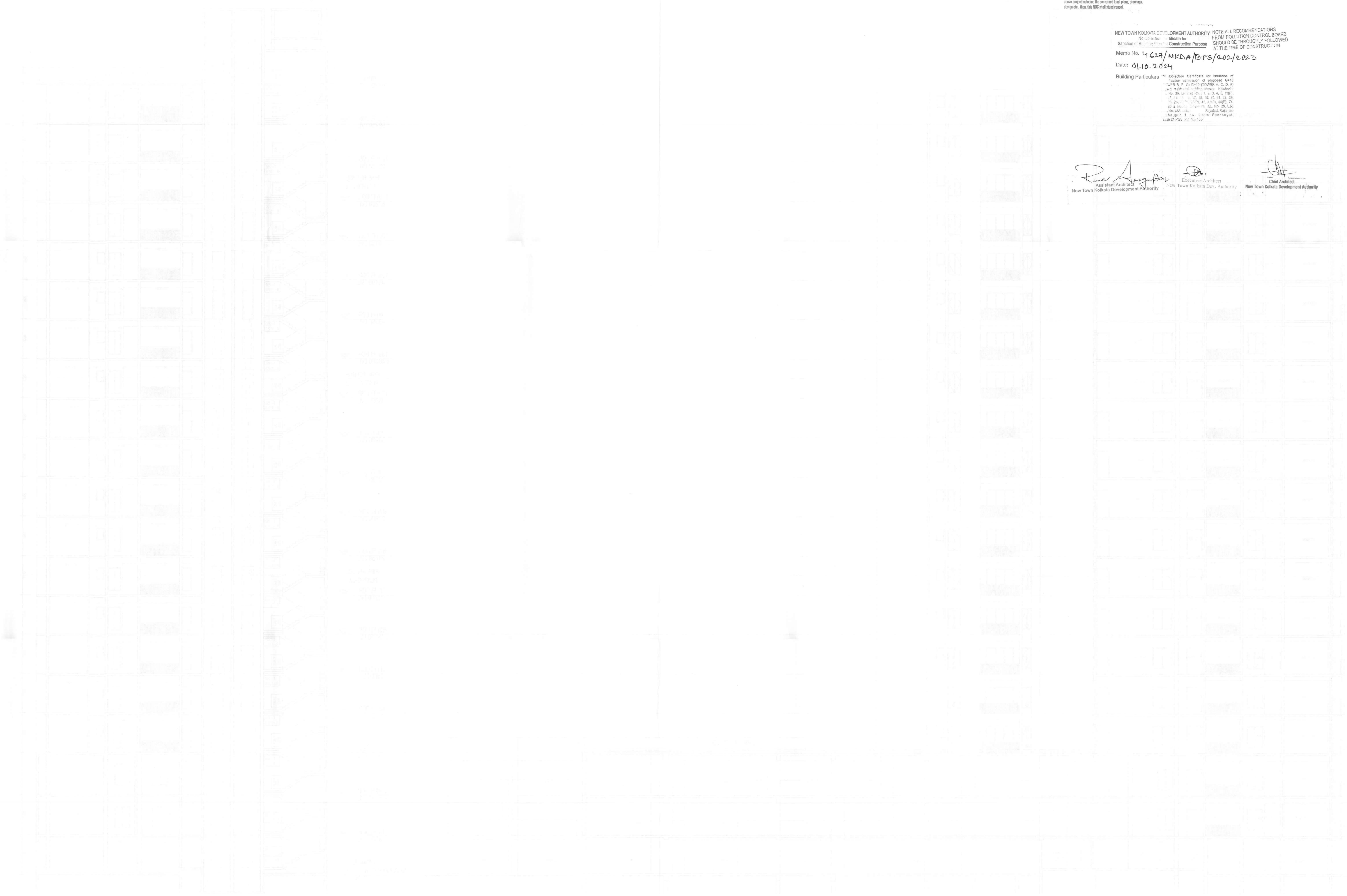

SECTION XX

SECTION XX